

AERON

CLASSIC LUMBAR

Instructions

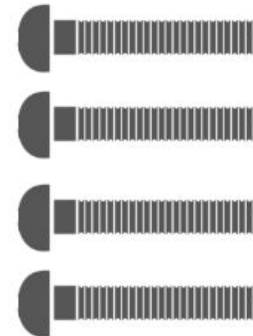
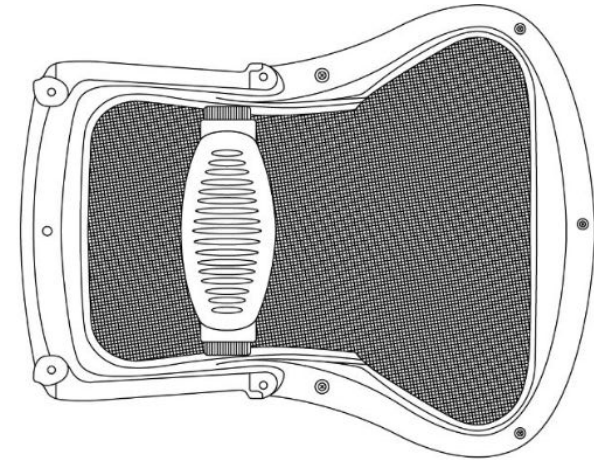
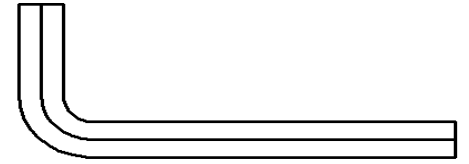
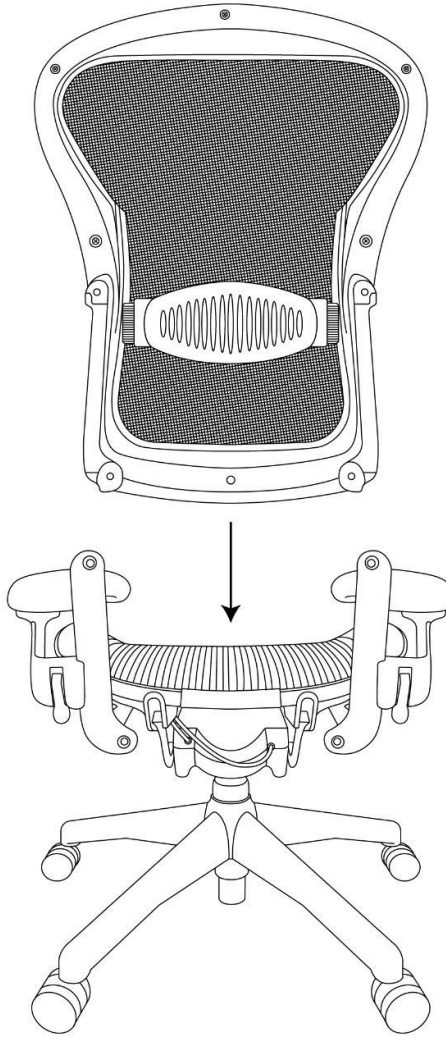
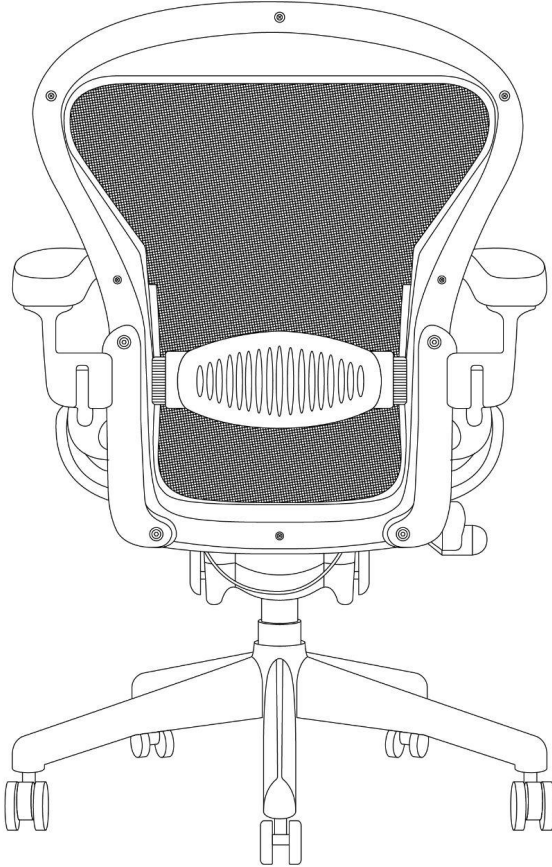

Scan for our video instructions and additional assembly support

1

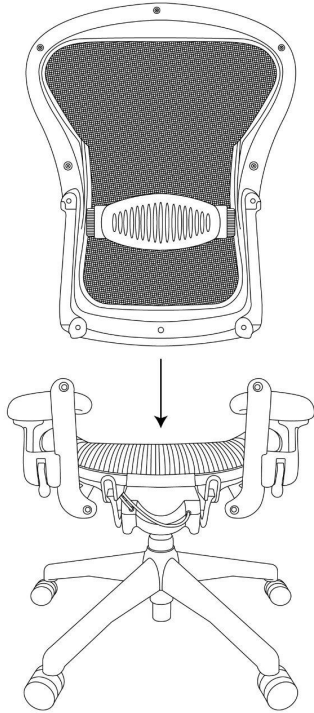

Mount the back mesh to the back of the frame making sure to align up the holes on each corner for the bolts

2

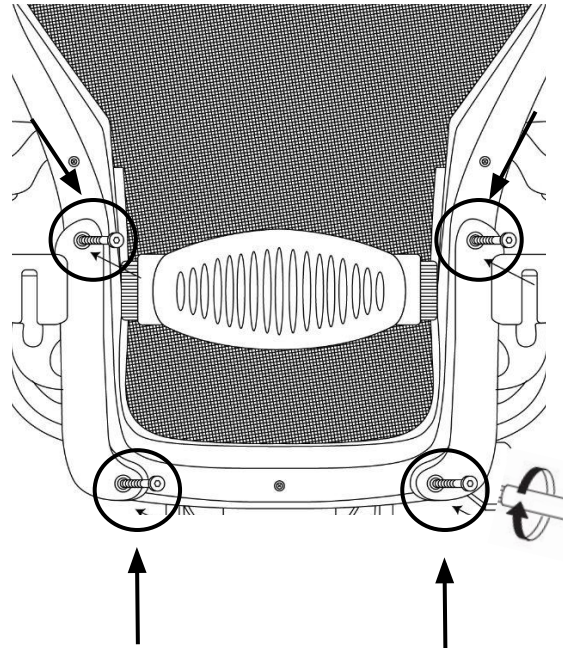

Screw the 4 bolts into the back of the mesh

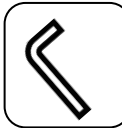

3

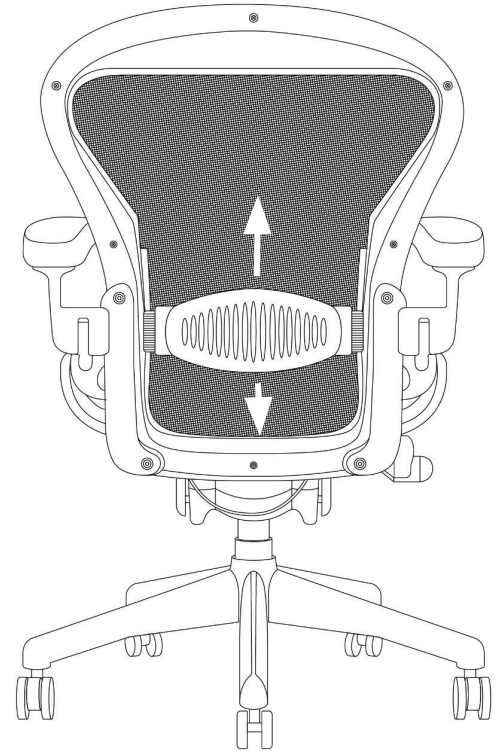

To adjust the lumbar pad - slide it up or down the rails, or switch the pad around to the other side. The pad is double sided one side being firmer than the other